

SOUTH ELEVATION

NORTH ELEVATION IS MIRROR IMAGE
WINDOW OPENINGS-SOUTH SIDE ONLY

WEST ELEVATION

EAST ELEVATION IS MIRROR IMAGE

DOOR & OPENING SCHEDULE

NO.	SIZE R.O.	DOOR/WINDOW	TYPE	FRAME	REMARKS/HARDWARE
①	3'-4"x7'-0"	SOLID STEEL	By Owner	STEEL	By Owner SEE NOTE 5 THIS SHEET
②	4'-0"x7'-4"	NONE	NONE	NONE	PLACE PRECAST LINTEL ACROSS OPENING, UNDER ROOF SLAB
③	3'-0"x9'-0"	NONE	NONE	NONE	N/A
④	2'-0"x3'-8"	SOLID STEEL	By Owner	STEEL	By Owner SEE NOTE 5 THIS SHEET

ROOM FINISH SCHEDULE

ROOM NAME	FLOORING(b)	WALL(a)	CEILING	HEIGHT
#1 & #2	SEALED CONCRETE	CONC. OR CONC.BLOCK	CONCRETE	8'-4"

(a) CONCRETE BLOCK WALLS SHALL BE NOMINAL 8" CMU, w/DURWALL HORIZONTAL @ EVERY SECOND OR THIRD COURSE AS NOTED.
(b) CONCRETE FLOORS SHALL BE NOMINAL 4" THICKNESS. ALL SURFACES SHALL RECEIVE ONE COAT OF A NON-FLAMMABLE CONCRETE SEALER/CURING COMPOUND.

GENERAL NOTES

- ALL WORK & MATERIAL SHALL BE IN COMPLIANCE WITH THE OHIO BASIC BUILDING CODE (LATEST EDITION) AND RELATED STATE & LOCAL CODES.
- ALL CONCRETE SHALL BE A MINIMUM OF 3,000 p.s.i. COMPRESSIVE STRENGTH @ 28 DAYS. ALL FLATWORK (i.e.: ROOF DECK & FLOOR SLAB) SHALL BE AIR ENTRAINED (MINIMUM 6% ±2%) CONCRETE WITH A SHRINKAGE COMPENSATING ADDITIVE INCLUDED. THE SPECIFICATIONS AND DOSAGE FOR THE SHRINKAGE COMPENSATING ADDITIVE SHALL BE FURNISHED TO THE ENGINEER FOR APPROVAL PRIOR TO CONSTRUCTION.
- EXTERIOR & INTERIOR DIMENSIONS ARE TAKEN TO FACE OF WALLS.
- HEAVY METAL DOORS, WINDOWS & FRAMES BY OWNER, ALL DOORS SHALL REMAIN UNLOCKED AT ALL TIMES WHEN THE BUILDING IS IN USE.
- FLOOR DRAINAGE PIPING SHALL BE PVC SCHEDULE 40 MEETING THE REQUIREMENTS OF ASTM D 1785-83.
- ALL HOLLOW LOAD BEARING CONCRETE MASONRY UNITS SHALL MEET THE SPECIFICATIONS OF ASTM C-90 GRADE N-1, AND SHALL BE SET IN TYPE M OR S MORTAR. BLOCK AT CORNERS AND WALL OPENINGS SHALL BE FACTORY PRODUCED FINISHED CORNER UNITS. LINTEL BLOCK, VERTICAL & HORIZONTAL REINFORCING SHALL BE AS SHOWN ON THE DETAILS HEREIN.
- AS AN ALTERNATIVE TO THE CONC. MASONRY WALL UNITS THE CONTRACTOR MAY UTILIZE 8" POURED CONCRETE WALLS. CONCRETE SHALL MEET THE REQUIREMENTS OF NOTE "2" ABOVE. CONTRACTOR SHALL SUBMIT SHOP DRAWINGS FOR WALL REINFORCEMENT TO THE ENGINEER FOR APPROVAL.
- ALL STEEL REINFORCING BARS SHALL MEET THE SPECIFICATIONS OF ASTM A615, GRADE 60.

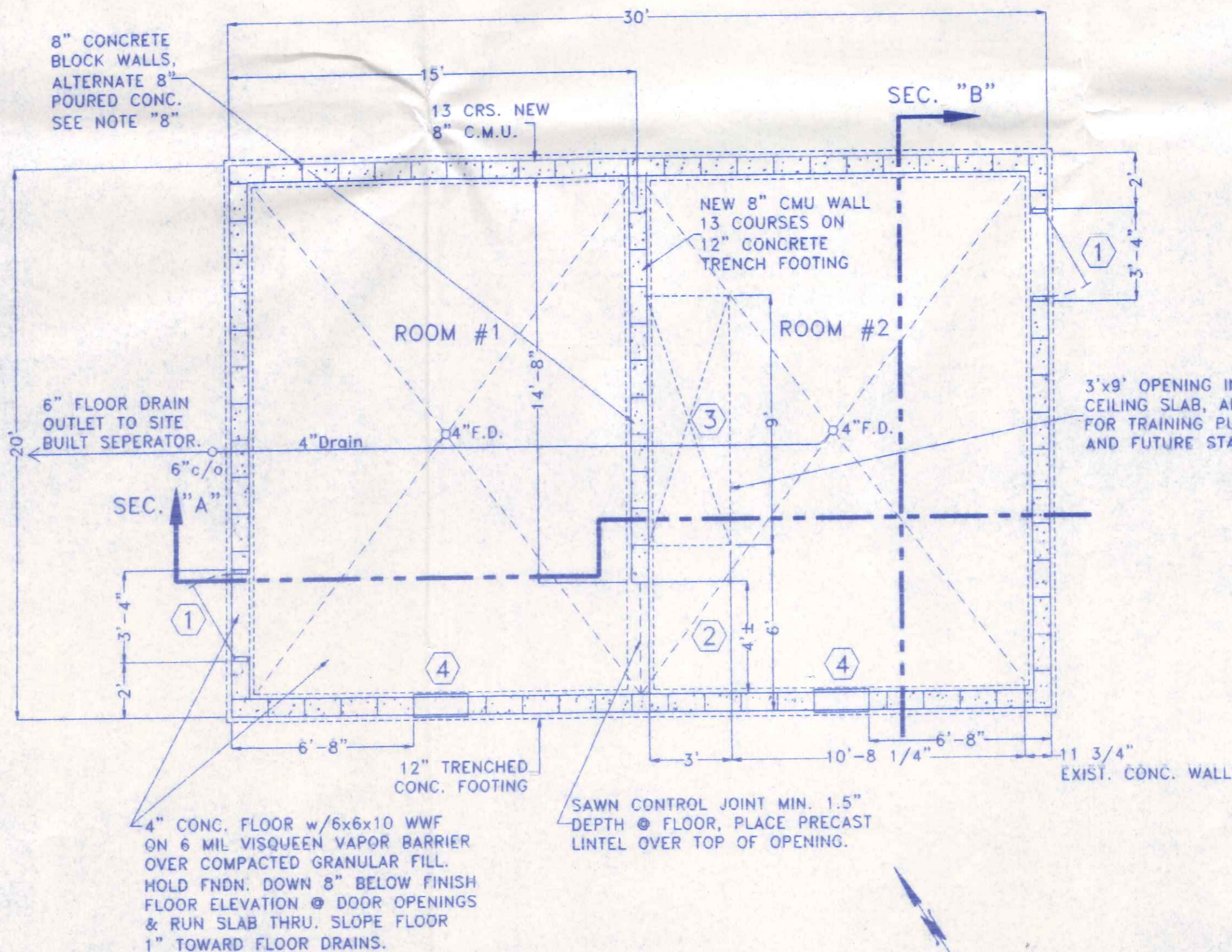

FLOOR PLAN



Richard F. Bertz
8/14/98

BUILDING DATA:

USE GROUP : "B" FIRE DEPT. SEE SEC. 305.2 OBBC
(USED FOR TRAINING/EDUCATIONAL PURPOSES.)
CONSTRUCTION TYPE : 2A, PROTECTED NON-COMBUSTIBLE
AREA : ALLOWABLE: 34,200 SQ. FT. (Table 503)
PROPOSED: 600 SQ. FT.
HEIGHT : ALLOWABLE: 85' - 7 STORY
PROPOSED: 84' - 1 STORY
MAXIMUM OCCUPANCY LOAD: 10 PERSONS (Estimated Actual)
MAXIMUM EXIT ACCESS TRAVEL DISTANCE : 200' ALLOWABLE
35' PROPOSED
DESIGN LOADS : FLOOR: 125 psf. LIVE LOAD plus DEAD LOAD
ROOF: 125 psf. LIVE LOAD plus DEAD LOAD
25 psf. MIN. GROUND SNOW LOAD
WIND: 80 mph wind speed,
EXPOSURE "B"
SOIL BEARING CAPACITY: 2,000 p.s.f. (Class 5 Soils)
SEISMIC ZONE INFORMATION:
Av = 0.077
Ag = 0.10
HAZARD EXPOSURE GROUP = GROUP 1
PERFORMANCE CATEGORY = B
SOIL PROFILE TYPE = S4
BASIC STRUCTURAL SYSTEM = 2
R = 3.5 Cd = 3
ANALYSIS PROCEDURE = ELF, (1610.4)

INDEX OF DRAWINGS:

- EXTERIOR ELEVATIONS & BUILDING DATA FLOOR PLAN, & INDEX OF SHEETS
- SITE PLAN
- CROSS SECTIONS, DETAILS & NOTES.



NAPOLEON FIRE DEPARTMENT	
E. RIVERVIEW AVENUE 419-592-0441	NAPOLEON, OHIO
DIRECTORY: C:\NOV\NAPOLEON CITY	FILE NAME: BURNBLDG.DWG
DRAWN BY: R.D.S. ~ dbe: NEW DIMENSIONS	REVISION: AUG. 1998
EXTERIOR ELEVATIONS, BUILDING DATA	SCALE: 1/4" = 1'
FLOOR PLAN & INDEX OF SHEETS	DATE: APRIL, 1998
	DRAWING NUMBER: 1 of 3